

**B WESTEN** ARCHITEKTONISCH / STÄDTEBAULICH  
BESSERE LÖSUNG ALS A

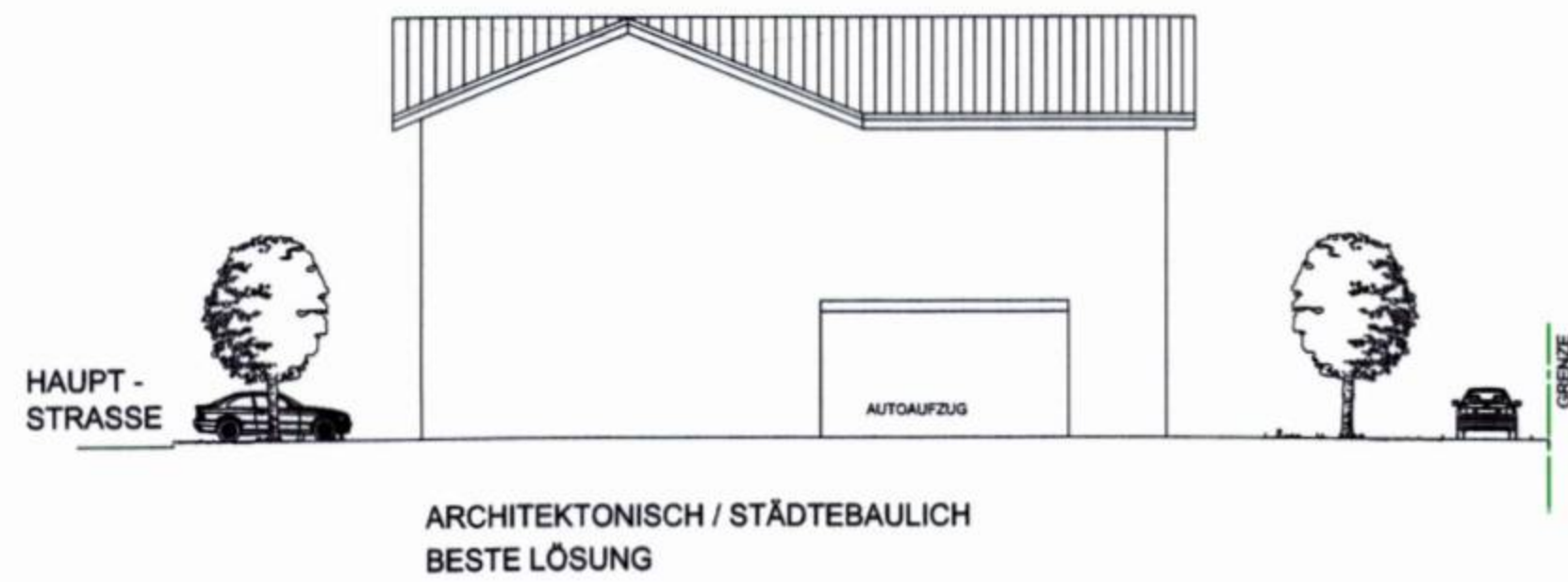

**C WESTEN**

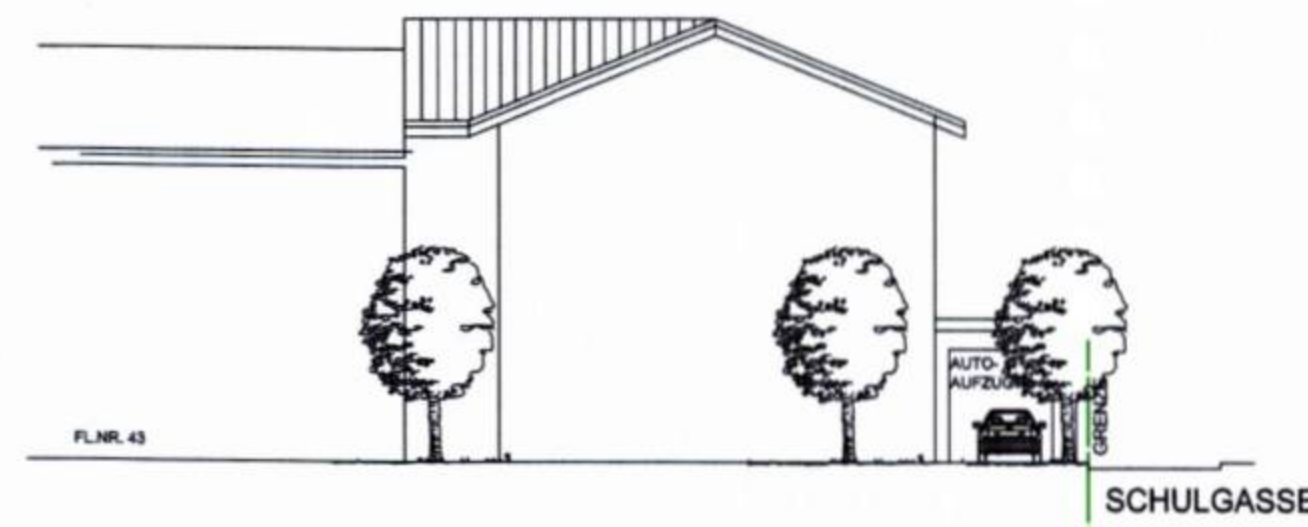

**B NORDEN**

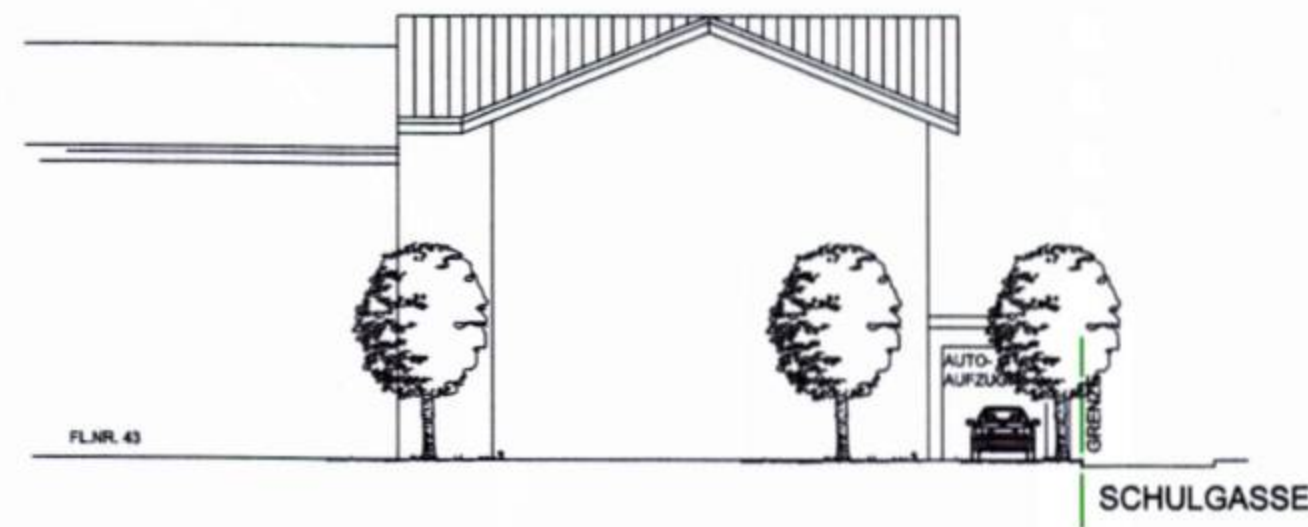

**C NORDEN**

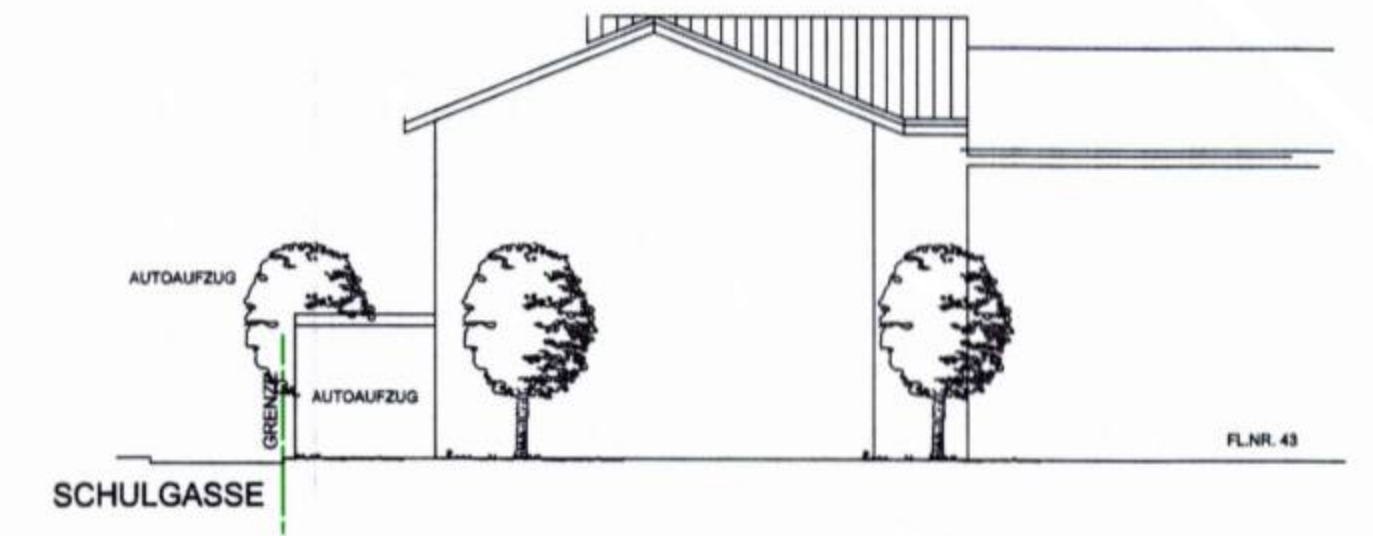

**B SÜDEN**

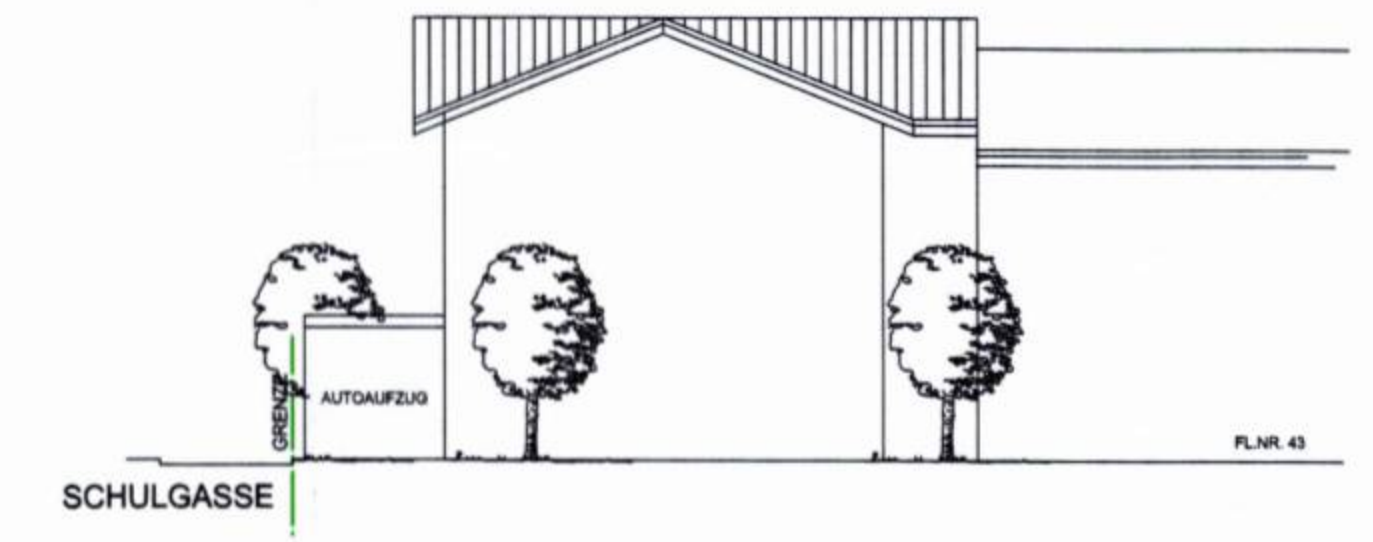

**C SÜDEN**

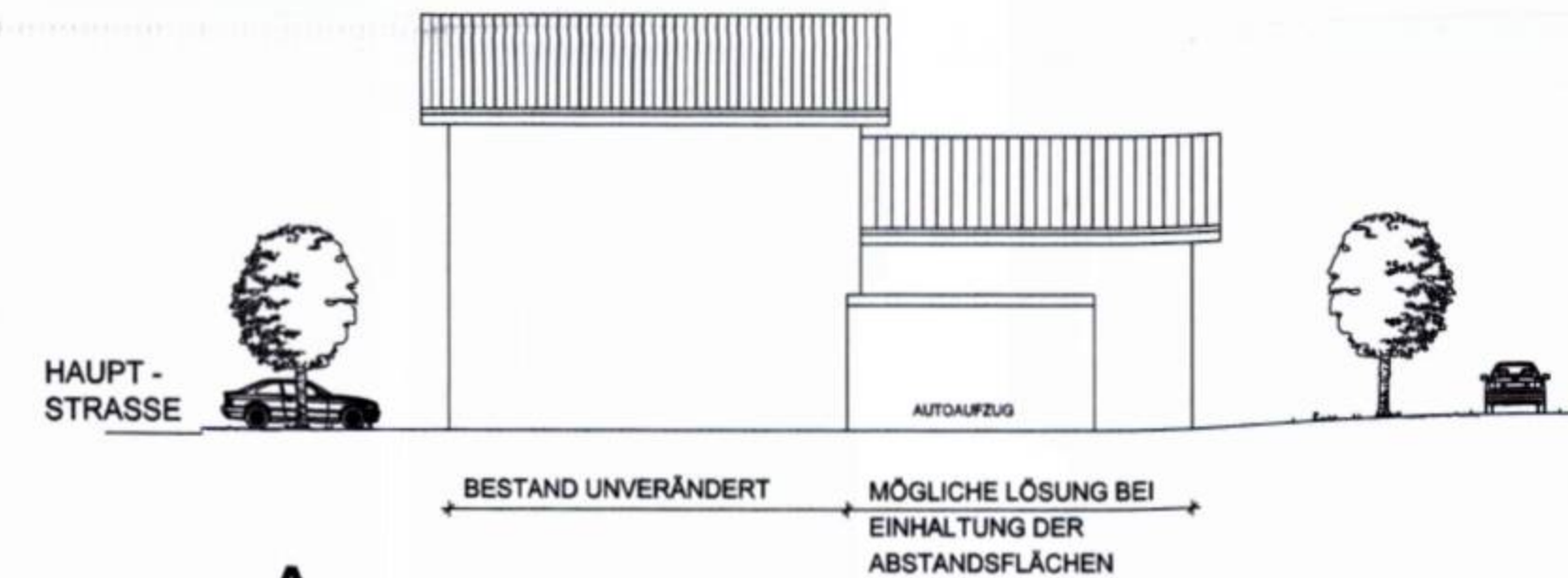

**A WESTEN**

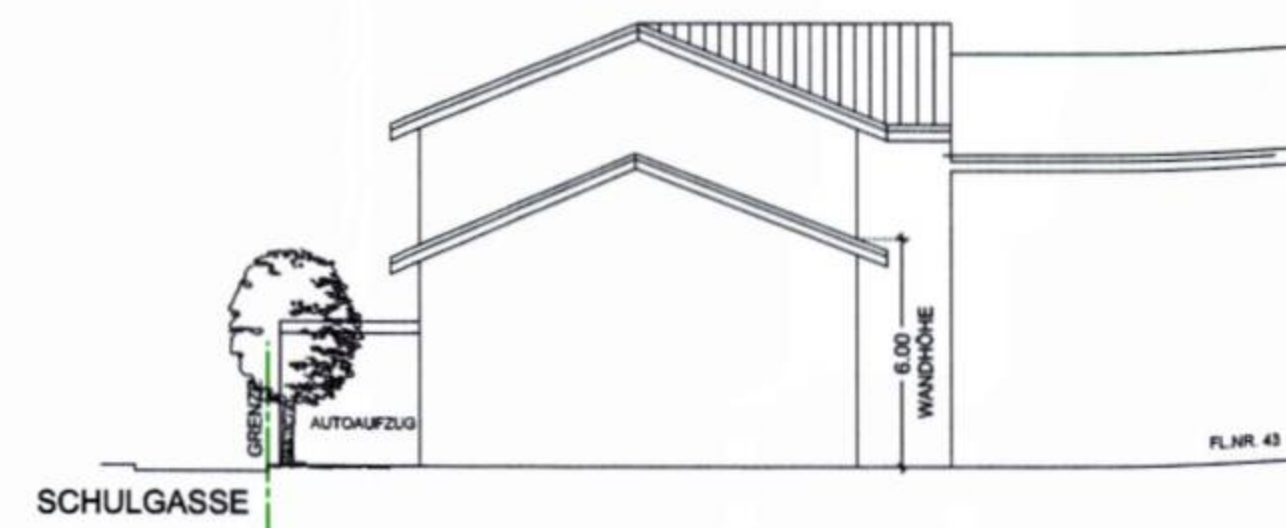

**A SÜDEN**  
NORDSEITE UNVERÄNDERT

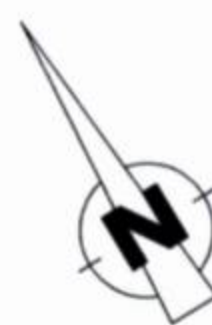
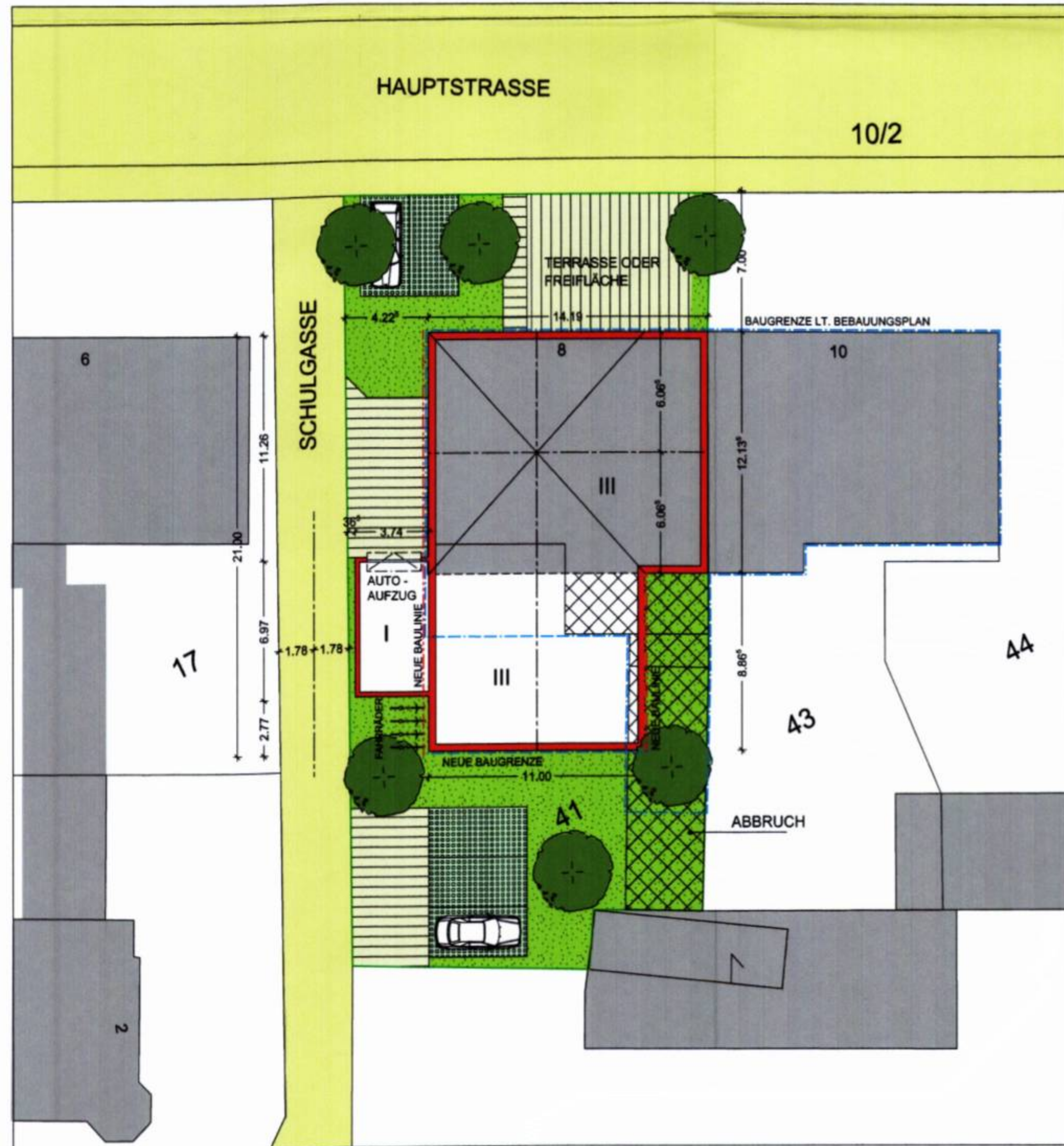

GRUNDRISS / LAGEPLAN

## ANTRAG AUF ÄNDERUNG DES BEBAUUNGSPLANES "SEESHAUPT - ORTSMITTE II"

ÄNDERUNG DER SÜDLICHEN BEBAUUNG  
82402 SEESHAUPT, HAUPTSTR. 8, FL.NR. 41

ANTRAGSTELLER :

NOVOTERRA IMMOBILIEN AG  
GF. KLAUS KLEINMICHEL  
EICHENWEG 1  
82541 MÜNSING

LAGEPLAN  
FASSADENSTUDIE

M 1 : 200

ENTWURFSVERFASSER :

BÖGL PLANUNGS GMBH  
DEUTENHAUSENER STR. 4  
82362 WEILHEIM

WEILHEIM, 01.03.2017





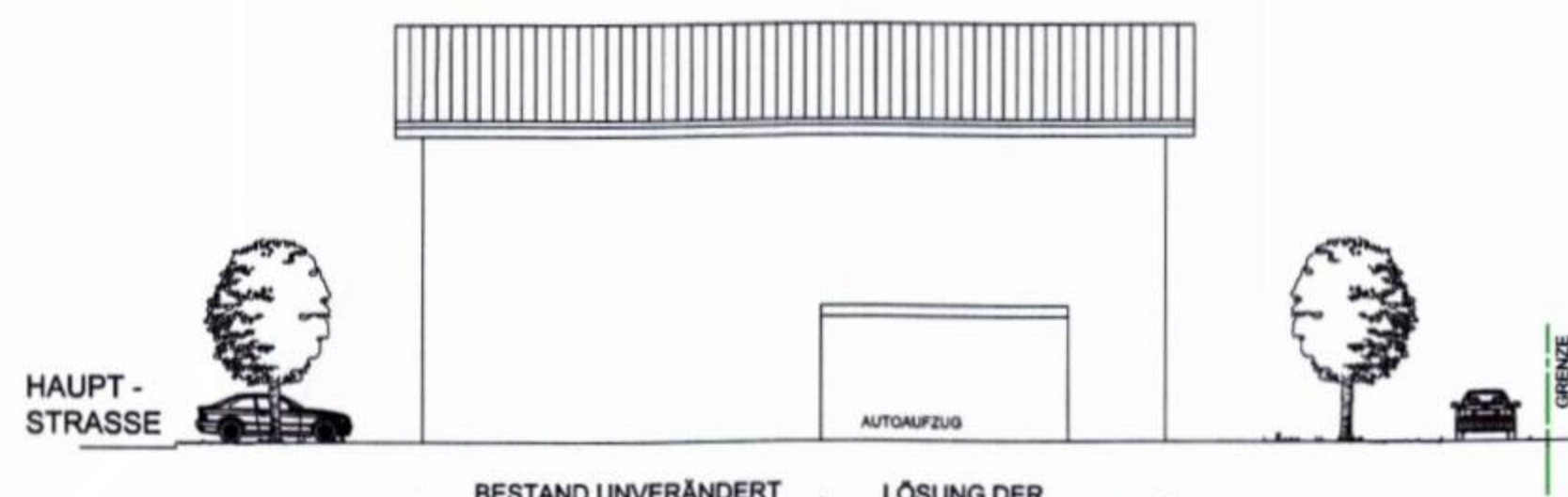

**B WESTEN** ARCHITEKTONISCH / STÄDTEBAULICH  
BESSERE LÖSUNG ALS A

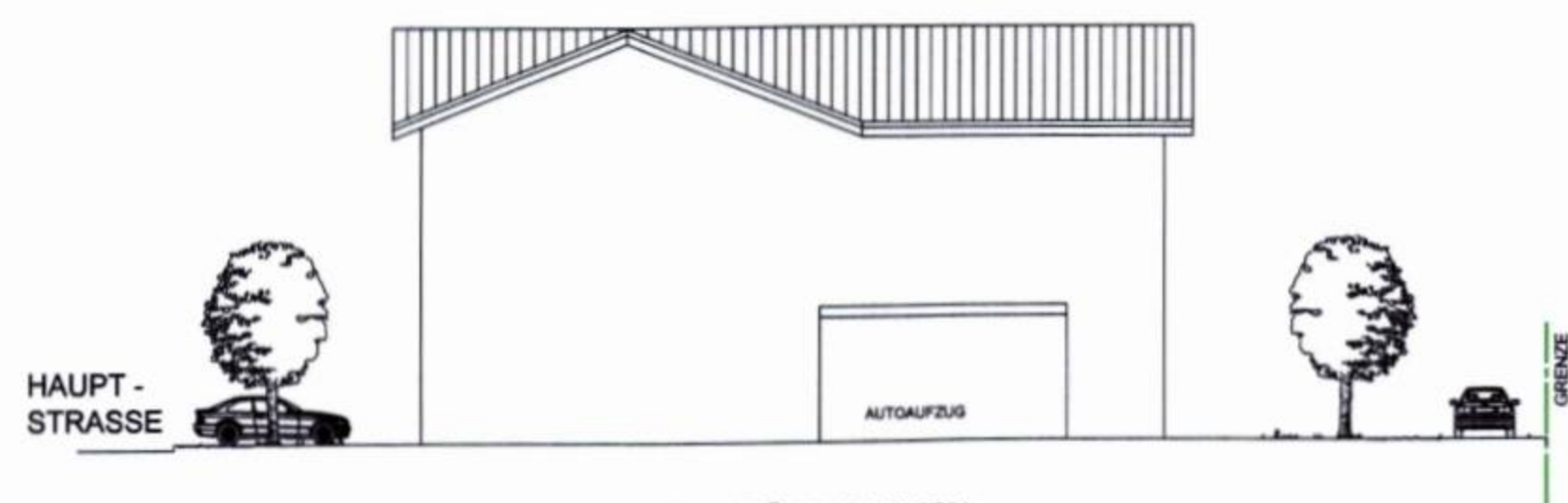

**C WESTEN** ARCHITEKTONISCH / STÄDTEBAULICH  
BESTE LÖSUNG

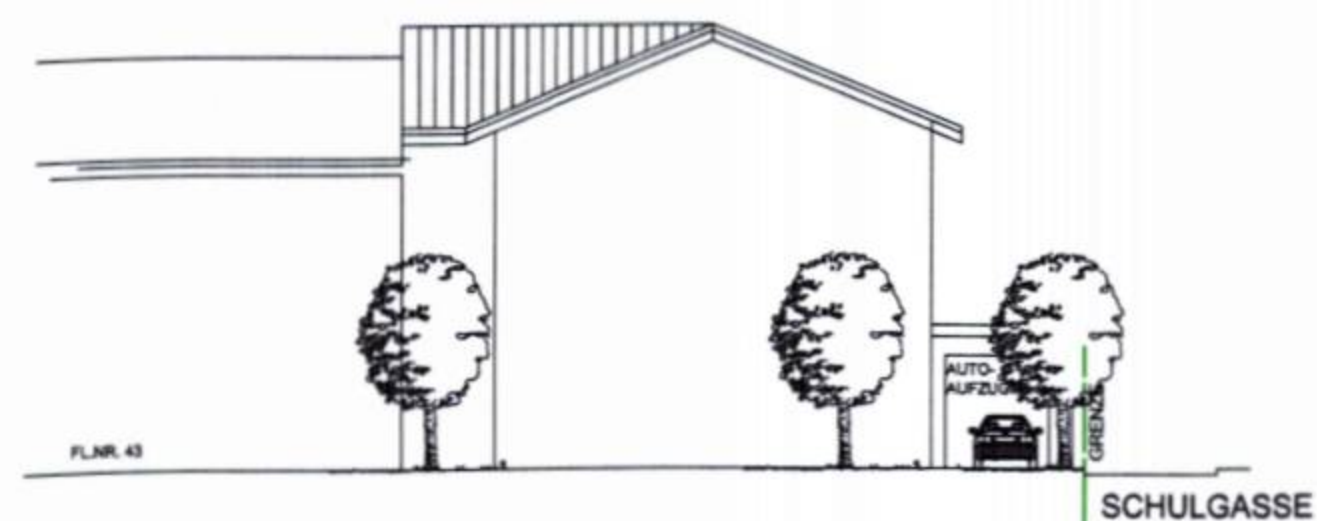

**B NORDEN**

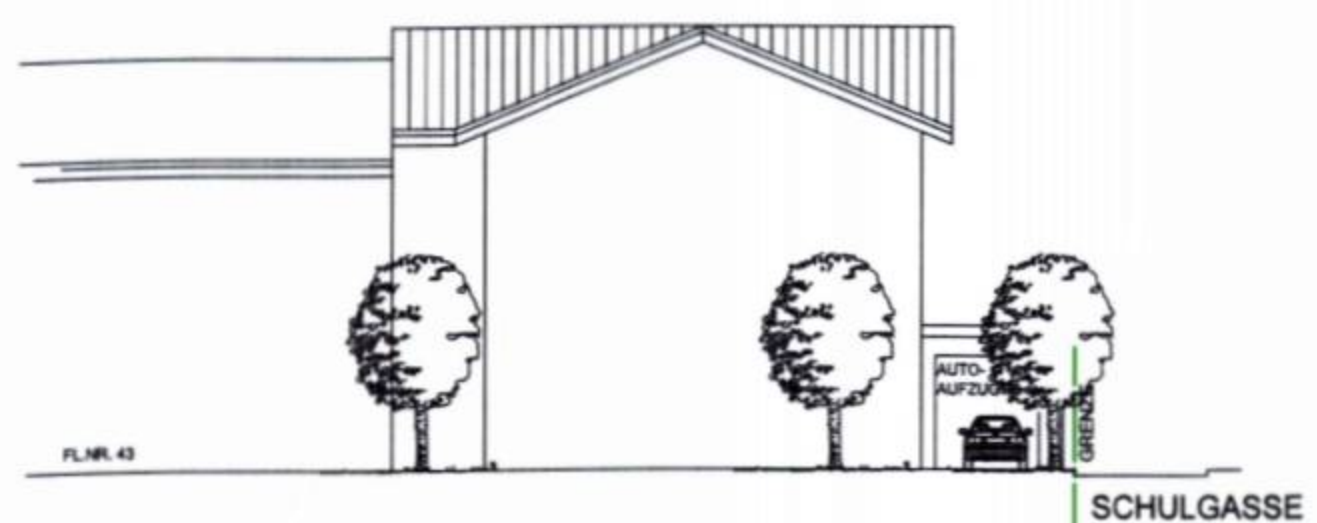

**C NORDEN**

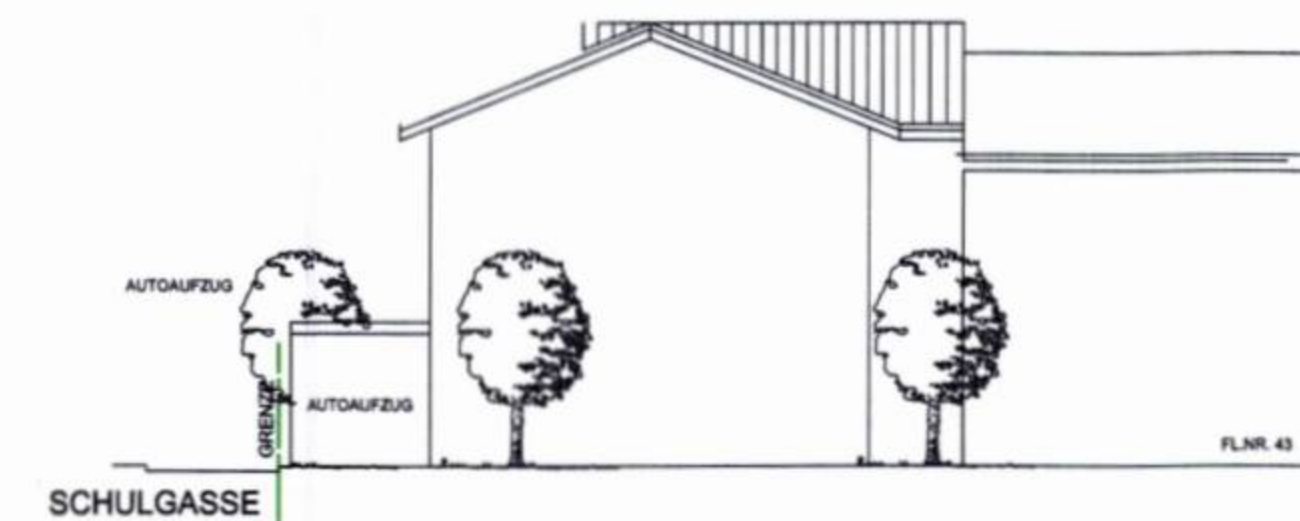

**B SÜDEN**

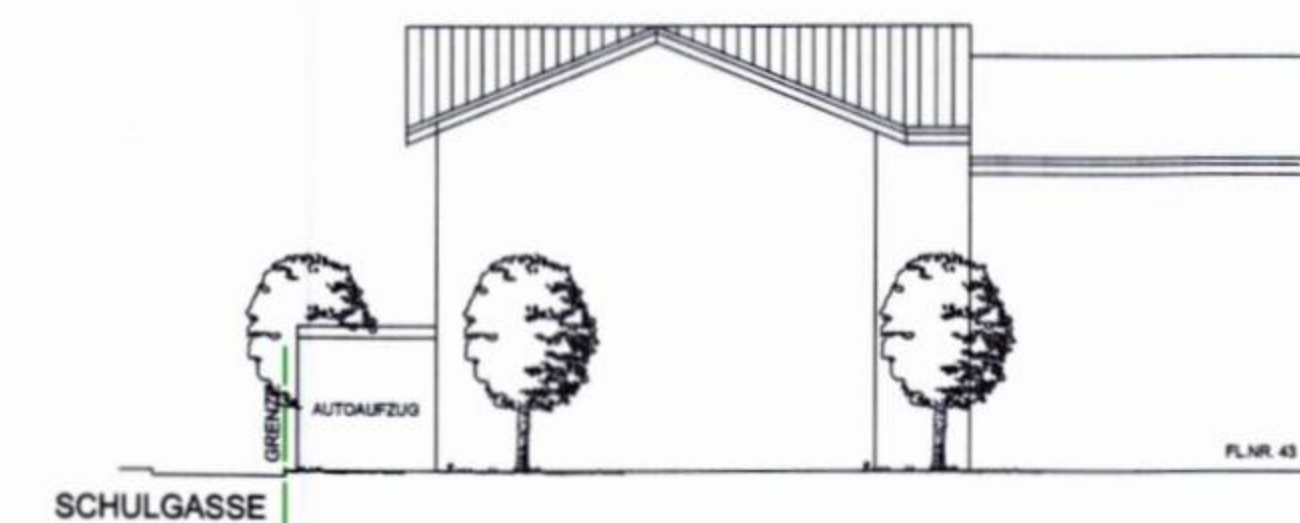

**C SÜDEN**

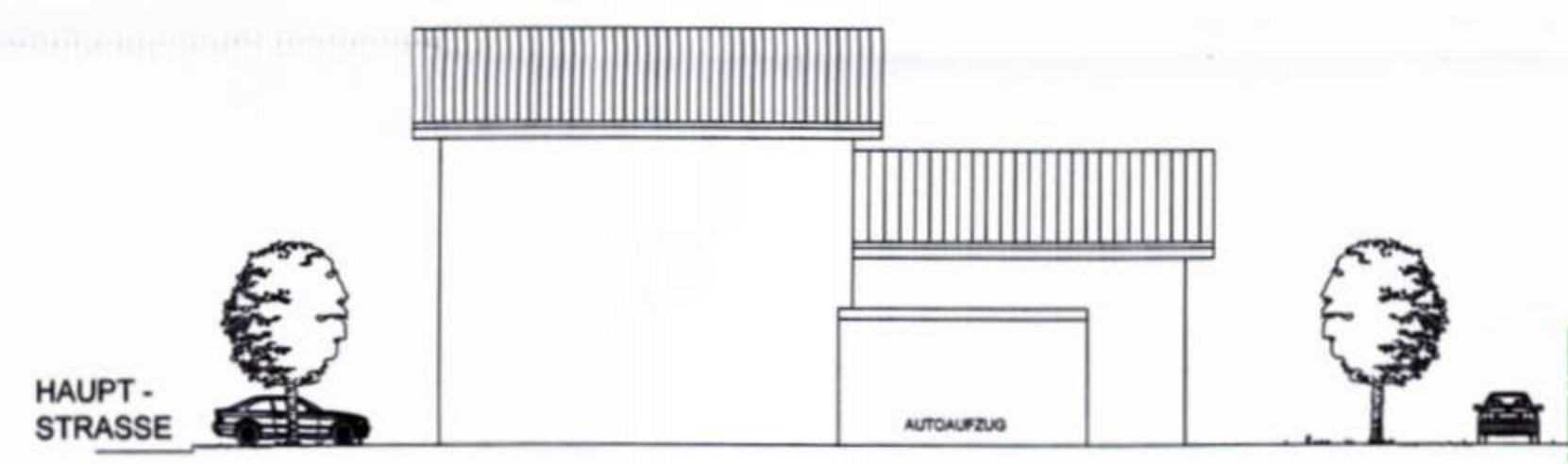

**A WESTEN**

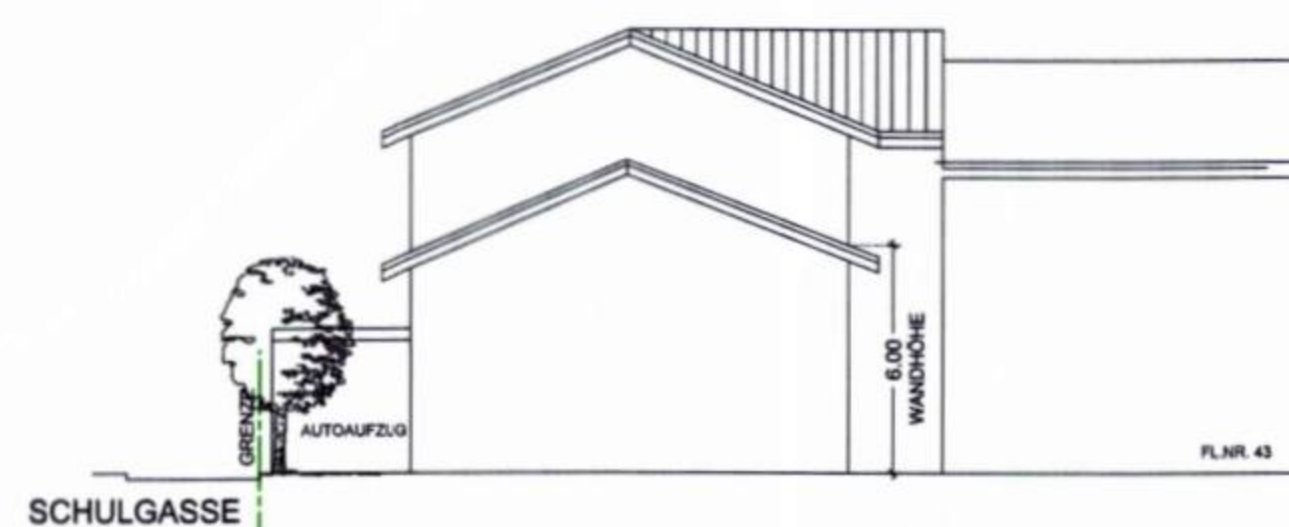

**A SÜDEN**  
NORDSEITE UNVERÄNDERT

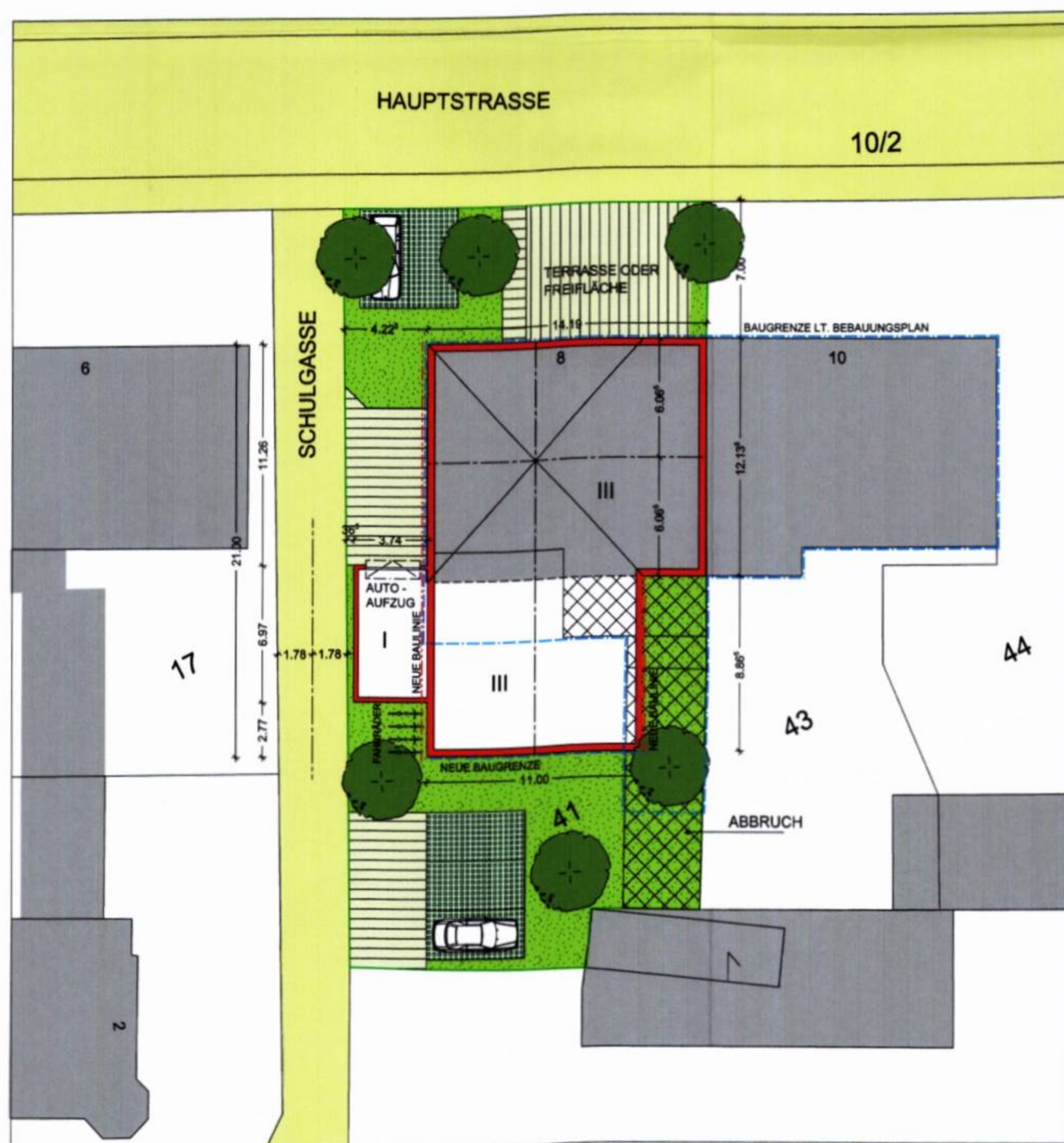

GRUNDRISS / LAGEPLAN

## ANTRAG AUF ÄNDERUNG DES BEBAUUGSPANES "SEESHAUPT - ORTSMITTE II"

ÄNDERUNG DER SÜDLICHEN BEBAUUNG  
82402 SEESHAUPT, HAUPTSTR. 8, FL.NR. 41

ANTRAGSTELLER :

NOVOTERRA IMMOBILIEN AG  
GF. KLAUS KLEINMICHEL  
EICHENWEG 1  
82541 MÜNSING

LAGEPLAN  
FASSADENSTUDIE

M 1 : 200

ENTWURFSVERFASSER :

BÖGL PLANUNGS GMBH  
DEUTENHAUSENER STR. 4  
82362 WEILHEIM

WEILHEIM, 01.03.2017

